



PUT 108 Description

| | |
|----------|------------------------------|
| Area | 20 miles east of Gainesville |
| Lot Size | 2.5 acres |
| No. Lots | One |
| Price | \$29,900 |

This heavily treed parcel slopes gently down to the lake. Nature at its best with oaks and pines. At \$29,900 you can't miss.

Directions to the Property

| | |
|---|--|
| 1 | From the intersection of CR 21 and SR 20, go east for about 1 mile to Lake Shore Dr. and turn left (north). |
| 2 | Go until it ends at the "T" and turn left. There is no street sign but the street is South Carolina St. |
| 3 | Go until it ends at Maryland St. and turn right. |
| 4 | Go for 3 blocks to Windy Hills Rd. and turn right. |
| 5 | Go for a short distance. On your left, is a mailbox with a "160 Windy Hills Rd." address on it. There is a small driveway next to the mailbox. |
| 6 | Turn left onto the drive and follow it until it ends. |
| 7 | There is a new house directly in front of you. Your property is the lot to the left of the new house, down to the lake. |

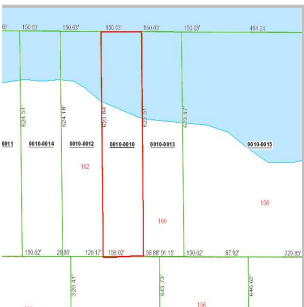

Plat of the Property

Call 941.778.7980 or 941.725.2051
for additional details.